

Applications



Pharma



Biotech



Research Labs



Multiplex



Airports



IT & Software



Hotels



Hospitals



STEP 1 **Planning- Rely On 'CHEMIETRON'.**

Planning is the essential part to any successful project. We take pride in partnering with our customers to ensure our solution provides optimum system performance, designed in flexibility to meet the changing requirements and ease of maintenance for the life of the unit. CHEMIETRON offers the innovative design solutions planned by its team of design engineers, project managers and field installation specialists.



STEP 2 **Custom Design and Manufacturing to Fit Your Needs.**

CHEMIETRON's fully customized units are engineered and tested to meet the most severe physical constraints with the versatility to meet all air handling needs in a variety of applications. All of our units are backed by expert design and engineering assistance with over 25 years of focused air handling unit design experience. Our unique design enables the performance capability whether the unit is built in the factory, built on-site, or retrofitted to an existing unit.



STEP 3 **System Design- Built For Quality. Built To Last.**

Our systems are built for reliability which translates to maximized equipment up-time. Reduced operational, service and maintenance costs, as well as replacement expenses, provide you with lower overall life cycle costs for your air handling unit. We use the highest quality industrial components to provide optimum system efficiency and superior equipment reliability. Our design focuses on service space, accessibility, and service features for ease of maintenance and serviceability. Factory piping, temperature control and full electrical services are available to meet your project requirements. CHEMIETRON offers equipment integrity and reliability unsurpassed in the industry, promoting a long-reliable life of providing excellent indoor air quality.



STEP 4 **Full Installation Services From Factory Trained Experts.**

CHEMIETRON offers complete field service installation capability, including on-site assembly, field supervision, start-up services, and training. The customer service team of CHEMIETRON, coordinates these field services. CHEMIETRON also has the unique ability to provide on-site assembly of units directly into the space required from factory fabricated pieces. On-site installation services allow assembly of air handling units in place while maintaining architectural prominence and integrity of the existing building.



STEP 5 **We're Your One-Source Custom Solution Provider.**

CHEMIETRON is committed to provide the highest quality service in the air handling unit industry by being your single source solution with design engineering, project management, field installation, testing and maintenance service. Our customer service technicians can be counted on for parts, service, support, engineering advice or maintenance for the life of your system.

*From initial design to post-installation technical support,
CHEMIETRON is your one-source solution provider.*

Insist on

Hygieno
SCARE
AHUs

CHEMIETRONTM
We provide Sterile Air
AN ISO 9001 : 2000 COMPANY

Factory : 590, Narol-Vatva Road, Nr. Sonal Process House, Ahmedabad-382405. GUJARAT.
Sales Office : 8-9, Devnandan Avenue, Bh. Seema Party Plot, Shyamal - Karnavati 100 ft. Road, Satellite, Ahmedabad - 380015. Gujarat, INDIA.
Phone: +91-79-6521 8306; 6525 1274; 2693 0168 **Fax:** +91-79-4006 1140
Mobile: +91-09825073114 / 09227742221 / 09227219462
E-mail: chemietron@hotmail.com chemietron@rediffmail.com

Web Site : www.chemietron.com

Introducing

Hygieno
SCARE
AHUs

CHEMIETRONTM
We provide Sterile Air
AN ISO 9001 : 2000 COMPANY



Hygienic

Total Solution for Clean Air- System



High Efficient Coils and Easy maintenance

Corrosion resistant coil construction features have galvanized steel casing and stainless steel header with threaded connections and extra thick tube walls & fins for longer life. Coils are selected with wider fin spacing to improve efficiency and facilitate maintenance. By incorporating these materials and professional manufacturing techniques, high coil performance as per ANSI / ARI Standard - 410 is assured.

Coil can be removed or serviced from either side of the unit without disturbing the other coils. Entire coil banks need not be disassembled simply to replace or repair one coil.



Improved Indoor Air Quality

- Flexible
- Energy efficient
- Low noise Level
- Wide range

Performance generally in accordance with ANSI / ARI Standard-430, AMCA, ISO 14644 & CEN Standards



High Performance Blowers (Like Kruger, etc.)

High energy efficient, AMCA certified, DIDW centrifugal blowers with forward/backward curved construction are available for medium to high static pressure applications. The electric motor is totally enclosed type with an IP 55 or 54 protection, Class F insulation. Withdrawable components and large inspection doors make maintenance easy.

Direct drive plug fans with inverter drive are also available on request.

Easy Access Filters

HEPA filters with extremely high separation capacity are installed in clean rooms, operating theatres and other hygienic ventilation applications. The mounting of the filter is extremely important, if the system is to conform to the stringent demands.



Convenient Access Door

Access door is provided with hinges & quick release latch for easy opening/access to all internals of AHU. The hinge & latch are made out of glass fibre to provide a smooth operation thru out its life.



Mixing Box with dampers

A damper is used in the AHU for Shutoff and adjustment of the air flow. The damper is supplied with Mixing box for better mixing and controls of fresh air & return air. Mixing box is equipped with parallel/opposite blade dampers for tight closure. Our newly improved damper is designed for the Indian climate.



Anti-vibration Isolators

Fan & motor is mounted on a common extruded aluminium channel base by using anti-vibration spring isolators and rubber anti-vibration pads ensuring low operating noise & Vibration. This eliminates the need for flexible coil connections and thus save installation cost.



Withdrawable Drain Pan for ease of cleaning

The Drain pan is made of aluminum / GI with dual slope to facilitate immediate discharge of condensate. This specially designed drain pan with all round edges allow complete cleaning and avoid microbial growth. Drain pan in SS construction is also available as an option. Also an effective and hygienic water seal is provided to siphon the condensate

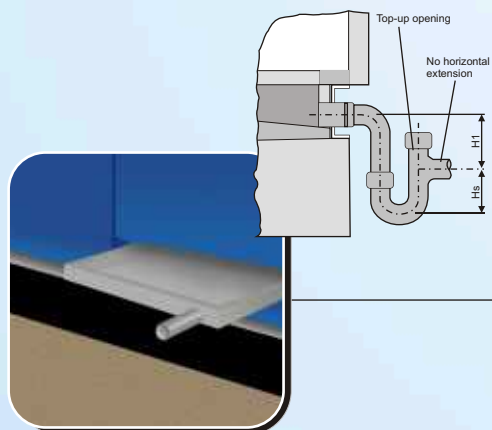

The fan section access door is electrically interlocked to the fan motor through a limit switch. This ensure human safety by switching off the fan motor whenever the door is opened for inspection/service.



CHEM|ETRON™
We provide Sterile Air
AN ISO 9001 : 2000 COMPANY

Double Skinned Casing with AI, Frame & Injected PUF

The casing is made out of aluminium frame and bolted to sturdy corners made of composite material to provide a durable compact finish with double skin panels. The casing meets the performance requirements of the CEN standards. The panels are insulated thermally with injected PUF to provide low thermal conductivity factor coupled with good rigidity. While this airtightness meets all the commercial air-conditioning application requirements, it can also be used in the stringent clean room and industrial cooling applications.

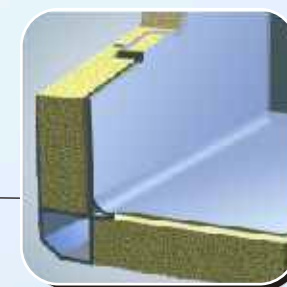

Coved internal sections for easy cleaning and better HYGIENE.